

## LED SPOT SMARTLINE COB



### SMARTLINE COB – RECESSED MOUNTED LED SPOT

As the perfect replacement for traditional halogen spotlights, these LEDSpots with an COB LED are available with a round or square frame and are ideal for use in furnitures, shelves and false ceilings.

A LEDSpot with rounded front part that clearly sets it apart from any other spotlights.

The elegant, simple design with rounded front part makes it perfect for creating the right lighting atmosphere. This LEDSpot differs clearly from any other spotlights.

#### Typical applications

- Furniture lighting
- Residential Lighting
- Retail lighting

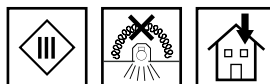

#### SmartLine COB

- **HIGH BRIGHTNESS: > 300 LM**
- **DEGREE OF PROTECTION: IP40**
- **NARROW COLOUR TOLERANCE: 3 SDCM**
- **HIGH QUALITY COB TECHNOLOGY**
- **FIXATION: SNAP-IN CLIPS OR SPRINGS FOR MANY DIFFERENT APPLICATIONS AND WALL THICKNESSES**
- **5 YEARS GUARANTEE**
- **MADE IN ITALY**



## SmartLine COB

**Complete LEDspot equipped with optics, heat sink, leads and metal frame**

### Technical notes

Metal frame, round or square

For cut-out: Ø 56 mm

LEDspot with one LED and with an aluminium heat sink

Beam angle: 40°

Colour accuracy initially: 3 SDCM

CRI R<sub>a</sub>: 80

Leads: Cu tinned, stranded conductors AWG22,

PVC-insulation, length: 250 mm

Use of external LED constant-current drivers

Snap-in clips or springs for easy installation  
for luminaire sheets (type LCH-017 and -020)

for ceilings (type LCH-019 and -021)

Degree of protection: IP40

Allowed ambient temperature: 0 to 35 °C

Allowed storage temperature: -30 to 60 °C

Lumen maintenance L70/B50:

50,000 hrs. (t<sub>c</sub>/t<sub>p</sub> = 70 °C)

Max. operating temperature at t<sub>c</sub> point: 90 °C

Weight: 60 g

Packaging unit:

45 pcs. (type LCH-017 and -020)

40 pcs. (type LCH-019 and -021)

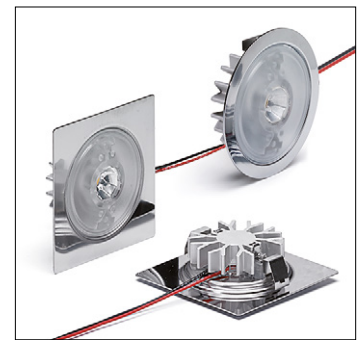

**LCH-017**

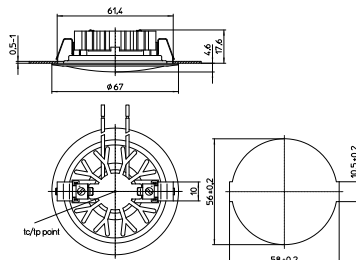

**LCH-019**

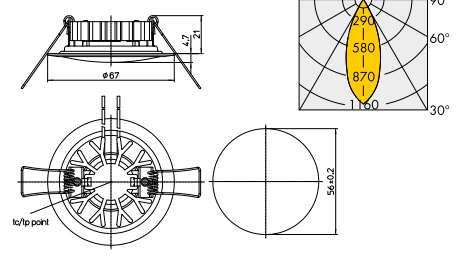

**LCH-020**

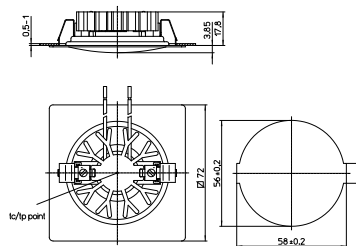

**LCH-021**

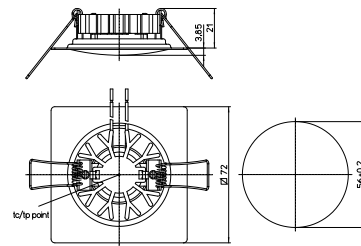

Type	Description	LEDspot Version		Colour	Correlated colour temperature K	Luminous flux (lm) and typical voltage (U <sub>yp.</sub> ) and power consumption (P <sub>el</sub> )*		Light intensity at max. current Candela	Frame shape		Energy efficiency at max. current
		for luminaire sheets	ceilings			min.	typ.		round	square	
All types	Smart COB 3000K 40°	<b>A</b>	<b>C</b>	warm white	3000	280	310	370	round	square	A++
All types	Smart COB 4000K 40°	<b>B</b>	<b>D</b>	neutral white	4000	300	330	405	round	square	A++

Emission data at t<sub>c</sub> = 25 °C | \*Production tolerance of luminous flux, voltage and power consumption: ±5% | Further colour temperatures on request

Frame colour	For luminaire sheets (LCH-017 and LCH-020)				For ceilings (LCH-019 and LCH-021)			
	Ref. No. <b>A</b> (warm white)		Ref. No. <b>B</b> (neutral white)		Ref. No. <b>C</b> (warm white)		Ref. No. <b>D</b> (neutral white)	
	round	square	round	square	round	square	round	square
silver	<b>564645</b>	<b>564655</b>	<b>564648</b>	<b>564657</b>	<b>564650</b>	<b>564659</b>	<b>564652</b>	<b>564661</b>
white	<b>564647</b>	<b>564656</b>	<b>564649</b>	<b>564658</b>	<b>564651</b>	<b>564660</b>	<b>564653</b>	<b>564662</b>

Silver brushed or further colours on request

### LED driver

You will find more information about our LED drivers on our website: [www.vossloh-schwabe.com](http://www.vossloh-schwabe.com)

Capacity range W	Output current DC mA	Output voltage DC V	Ref. No.	Version	Current setting	Dimming	Max. service life time (hrs.)	Dimensions: mm (LxWxH)
<b>350 mA</b>								
7	350	8.4–20	<b>186342</b>	EasyLine	—	—	50,000	81.6x42.5x23
9	350	2–25	<b>186519</b>	ComfortLine	—	—	100,000	65x30.7x21.5
11	350	2–32	<b>186679</b>	ComfortLine	—	—	100,000	128x37x28
12.6	350	8.4–36	<b>186341</b>	EasyLine	—	—	50,000	122.8x45x19

Please ensure you choose the correct LED driver for the module in question and that the respective output parameters (current, voltage, wattage) are correct.

The values contained in this data sheet can change due to technical innovations. Any such changes will be made without separate notification.

## SmartLine COB – Installation Instruction

### General safety information

- VS product may only be installed and commissioned by authorised and fully qualified staff.
- These instructions must be carefully read before installing and commissioning the system, as this is the only way to ensure safe and correct handling.
- An external driver for 350 mA is required.
- Before any work is carried out on the equipment, it must be disconnected from the mains.
- All valid safety and accident-prevention regulations must be observed.
- The products should never be inexpertly opened. Repairs may only be undertaken by the manufacturer.
- Dimming: The dimming characteristics of the installed driver have to be observed.
- The photo biological safety of the LED modules is classified into risk groups in accordance with EN 62471: 2008 and IEC TR 62778: risk group 1.

See drawing and cut out for each product on previous pages

### Built-in

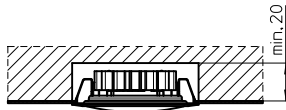

### Correct position

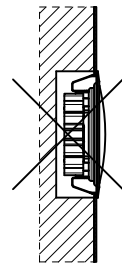
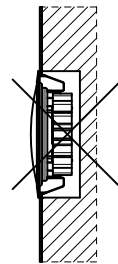
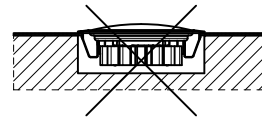
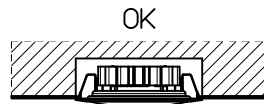

## All VS LED Spots at a glance

### Tiny

LEDSpot with optics, leads and metal frame  
For cut-out: Ø 26 mm  
Beam angle: 36°  
Lumen output: max. 140 lm  
Versions: CC, CV, Kit



### StartLine

LEDSpot with optics, heat sink, leads and frame  
For cut-out: Ø 56 mm  
Beam angle: 30°, 36°, 38°  
Lumen output: max. 250 lm  
Versions: CC, CV



### EffectLine

LEDSpot with optics, heat sink, leads and metal frame  
For cut-out: Ø 37 mm  
Beam angle: 10°, 16°, 28° or 38°  
Lumen output: max. 250 lm  
Versions: CC

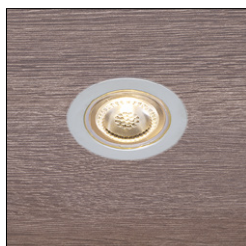

### IPLine

LEDSpot IP54 with optics, heat sink, leads and metal frame  
For cut-out: Ø 56 mm  
Beam angle: 40°  
Lumen output: max. 330 lm  
Versions: CC



### FlatLine

LEDSpot with optics, leads and metal frame  
For cut-out: Ø 56 mm  
Beam angle: 60°, 70°  
Lumen output: max. 270 lm  
Versions: CC, CV, TW, Kit



### DisLine

LEDSpot with optics, heat sink, leads and metal frame  
For cut-out: Ø 56 mm  
Beam angle: 45°, 55°  
Lumen output: max. 220 lm  
Versionen CC



### SmartLine COB

LEDSpot with optics, heat sink, leads and metal frame  
For cut-out: Ø 56 mm  
Beam angle: 40°  
Lumen output: max. 330 lm  
Versions: CC



### SoftLine

LEDSpot with heat sink, leads and metal frame  
For cut-out: Ø 56 mm  
Beam angle: 90°  
Lumen output: max. 225 lm  
Versions: CV



### SmartLine SMD

LEDSpot with optics, heat sink, leads and metal frame  
For cut-out: Ø 56 mm  
Beam angle: 36°, 40°  
Lumen output: max. 250 lm  
Versions: CC, CV



### Revo

LEDSpot with optics and frame  
For cut-out: 67.5x25x5 mm  
Beam angle: 60°, 70°  
Lumen output: max. 255 lm  
Versions: CC, CV, TW



The values contained in this data sheet can change due to technical innovations. Any such changes will be made without separate notification.